

SENCION

THREAT LIQUIDS DETECTOR



The Sencion was developed for the purpose of preventing items containing threat liquids (flammable or explosive liquids) from entering secured areas. This laptop sized detection device instantaneously and effectively analyzes liquids in bottles to determine if the bottles contain any threat liquids. It is designed for use at security checkpoints to enable individuals to carry their bottled liquids quickly and safely through any security checkpoint and simultaneously act as a powerful deterrent against terrorism.

BENEFITS:

- Automated detection
- Detection in less than 2 seconds
- No additional manpower
- Ready for use in 5-seconds
- No liquid spills in x-ray system
- Higher check-point throughput
- Compact size
- Easy installation
- Minimal training required
- Exceptional MTBF

SENCION

THREAT LIQUIDS DETECTOR

TECHNICAL DATA

Dimensions

W 291mm (11.5") D 231mm (9.1") H 75mm (3.0")

Weight

2.2kg (4.9lbs)

Detection method

Evaluates the physical properties (relative dielectric constant and resistivity) of liquids in a bottle by electromagnetic wave.

Temperature ranges

0-50° C, 32-122° F, 95% relative humidity (without dew)

Response time

Real time, 2 second response

Items detected

The list is extensive, but for security reasons cannot be disclosed. The threat liquids include both readily available commercial products and other regulated materials.

Included items

- 1 – Sencion Detector
- 1 – Power Cord
- 1 – AC Adapter
- 1 – Dust Cover
- 1 – Operation Manual

Warranty

1 year warranty against manufacturer's defects

Installation requirements

Flat, stable platform or table

Power requirements

Detector

Input Voltage : 12V DC 0.35A

AC Adapter

Input Voltage : 100-240V AC 50-60HZ 0.6A

Output Voltage :12V DC 1.25A

Applicable Standard : UL / CE / PSE etc.

COMPONENT NAMES AND FUNCTIONS

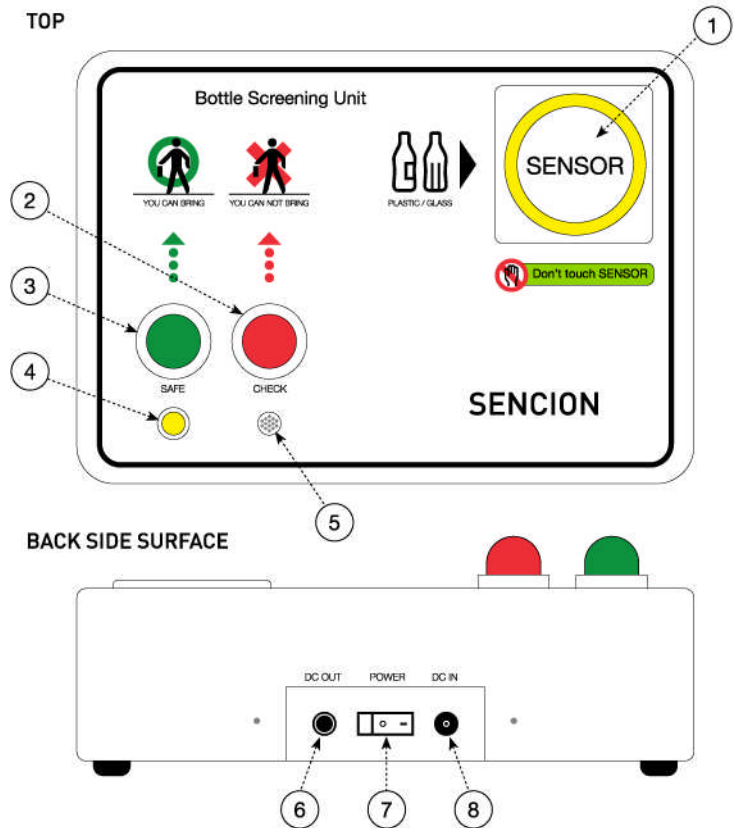

1. **SENSOR:** Area where bottle is placed to be analyzed.
2. **CHECK LAMP:** Illuminates when liquid is detected to be a threat.
3. **SAFE LAMP:** Illuminates when liquid is detected to be safe.
4. **POWER LAMP:** Illuminates while power is supplied to Detector.
5. **BUZZER:** Sounds when liquid is detected to be a threat liquid.
6. **DC OUT RECEPTACLE:** Allows for output data collection.
7. **POWER SWITCH:** Switch to turn power on or off to Detector.
8. **POWER CONNECTOR:** Connector for AC Adapter.

For Sales Contact:

Sellex International Sencion, Ltd.
88 E. Broad St., Suite 1220
Columbus, Ohio 43215
Tel: +01 614 463 1986
Fax: +01 614 463 1987

info@senciondetection.com
www.senciondetection.com